



Collet Holder - MDC

New series debut after our quest for...

User friendly!

High accuracy!

Good value for money!



Meaning of "NT-MEVIUS"

The Möbius (Meivius) strip is an one boundary surface. Since the Möbius strip does not have a starting or ending point, it often symbolizes "infinity" or "endlessness". The brand name "NT-MEVIUS" is created with NT's hope for everlasting growth and success of both customers and NT.

What's **NT-MEVIUS** Series?

NT-MEVIUS Series is tooling developed reflecting the needs from Asian market.

Manufactured by NT TOOL (THAILAND) Co., Ltd. under the strict QC system of NT TOOL CORPORATION in Japan.

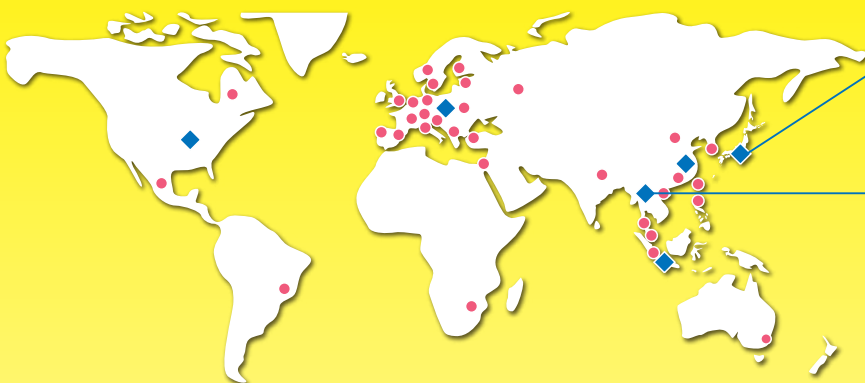

NT TOOL CORPORATION
in Japan



NT TOOL (THAILAND) Co.,Ltd.

Feature - User friendly

High accuracy $4d = 7\mu\text{m}!$



Sufficient Clamping Force

Black Coating

The holder body is entirely black oxide coated.



Coolant Feeding

Internal coolant feeding is possible by replacing the collet with FDC-OH or FDC-C type collet. Please contact NT TOOL for details.

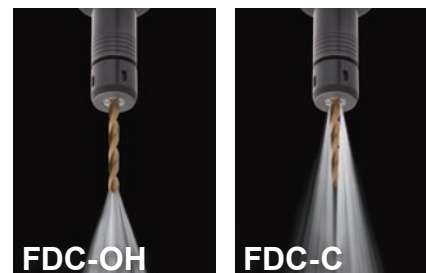

FDC-OH
For cutting tool with oil hole

FDC-C
For cutting tool without oil hole

Collet Holder - MDC

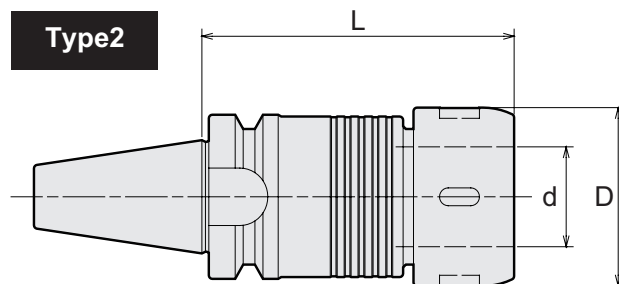
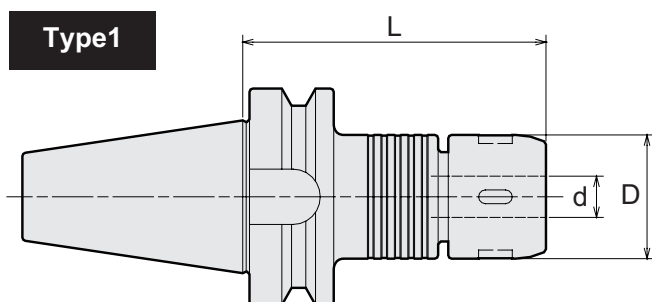

Code	Model	Type	d	D	L	Kg	Collet	Cap	Spanner
2530 03007060	BT30 -MDC07 -60	1	0.5 - 7.0	21	60	0.5	FDC-07M	MDP-07	FKM-21
2530 03007090	-90	1	0.5 - 7.0	21	90	0.5			
2530 03012090	-MDC12 -90	1	2.5 - 12.0	36	90	0.8	FDC-12M	MDP-12	FKM-36
2530 03012120	-120	1	2.5 - 12.0	36	120	1.0			
2530 03022090	-MDC22 -90	2	3.5 - 22.0	50	90	0.9	FDC-22M	MDP-22	FKM-50
2530 03022120	-120	2	3.5 - 22.0	50	120	1.2			
2530 04007060	BT40 -MDC07 -60	1	0.5 - 7.0	21	60	1.0	FDC-07M	MDP-07	FKM-21
2530 04007090	-90	1	0.5 - 7.0	21	90	1.1			
2530 04012090	-MDC12 -90	1	2.5 - 12.0	36	90	1.3	FDC-12M	MDP-12	FKM-36
2530 04012120	-120	1	2.5 - 12.0	36	120	1.5			
2530 04022090	-MDC22 -90	1	3.5 - 22.0	50	90	1.5	FDC-22M	MDP-22	FKM-50
2530 04022120	-120	1	3.5 - 22.0	50	120	1.9			

● Spanner, Collet, preset screw and retention stud are sold separately.

Ordering Example

BT30 - MDC 12 - 120

Shank size Max. collet I.D. Projection length

Collet - FDC

FDC-07M	
Tool shank dia.	Model
φ 0.5 - 1.0	FDC-01007M
φ 1.0 - 1.5	FDC-01507M
φ 1.5 - 2.0	FDC-02007M
φ 2.0 - 2.5	FDC-02507M
φ 2.5 - 3.0	FDC-03007M
φ 3.0 - 3.5	FDC-03507M
φ 3.5 - 4.0	FDC-04007M
φ 4.0 - 4.5	FDC-04507M
φ 4.5 - 5.0	FDC-05007M
φ 5.0 - 5.5	FDC-05507M
φ 5.5 - 6.0	FDC-06007M
φ 6.0 - 6.5	FDC-06507M
φ 6.5 - 7.0	FDC-07007M

FDC-12M	
Tool shank dia.	Model
φ 2.5 - 3.0	FDC-03012M
φ 3.0 - 3.5	FDC-03512M
φ 3.5 - 4.0	FDC-04012M
φ 4.0 - 4.5	FDC-04512M
φ 4.5 - 5.0	FDC-05012M
φ 5.0 - 5.5	FDC-05512M
φ 5.5 - 6.0	FDC-06012M
φ 6.0 - 6.5	FDC-06512M
φ 6.5 - 7.0	FDC-07012M
φ 7.0 - 7.5	FDC-07512M
φ 7.5 - 8.0	FDC-08012M
φ 8.0 - 8.5	FDC-08512M
φ 8.5 - 9.0	FDC-09012M
φ 9.0 - 9.5	FDC-09512M
φ 9.5 - 10.0	FDC-10012M
φ 10.0 - 10.5	FDC-10512M
φ 10.5 - 11.0	FDC-11012M
φ 11.0 - 11.5	FDC-11512M
φ 11.5 - 12.0	FDC-12012M

FDC-22M			
Tool shank dia.	Model	Tool shank dia.	Model
φ 3.5 - 4.0	FDC-04022M	φ 12.5 - 13.0	FDC-13022M
φ 4.0 - 4.5	FDC-04522M	φ 13.0 - 13.5	FDC-13522M
φ 4.5 - 5.0	FDC-05022M	φ 13.5 - 14.0	FDC-14022M
φ 5.0 - 5.5	FDC-05522M	φ 14.0 - 14.5	FDC-14522M
φ 5.5 - 6.0	FDC-06022M	φ 14.5 - 15.0	FDC-15022M
φ 6.0 - 6.5	FDC-06522M	φ 15.0 - 15.5	FDC-15522M
φ 6.5 - 7.0	FDC-07022M	φ 15.5 - 16.0	FDC-16022M
φ 7.0 - 7.5	FDC-07522M	φ 16.0 - 16.5	FDC-16522M
φ 7.5 - 8.0	FDC-08022M	φ 16.5 - 17.0	FDC-17022M
φ 8.0 - 8.5	FDC-08522M	φ 17.0 - 17.5	FDC-17522M
φ 8.5 - 9.0	FDC-09022M	φ 17.5 - 18.0	FDC-18022M
φ 9.0 - 9.5	FDC-09522M	φ 18.0 - 18.5	FDC-18522M
φ 9.5 - 10.0	FDC-10022M	φ 18.5 - 19.0	FDC-19022M
φ 10.0 - 10.5	FDC-10522M	φ 19.0 - 19.5	FDC-19522M
φ 10.5 - 11.0	FDC-11022M	φ 19.5 - 20.0	FDC-20022M
φ 11.0 - 11.5	FDC-11522M	φ 20.0 - 20.5	FDC-20522M
φ 11.5 - 12.0	FDC-12022M	φ 20.5 - 21.0	FDC-21022M
φ 12.0 - 12.5	FDC-12522M	φ 21.0 - 21.5	FDC-21522M
		φ 21.5 - 22.0	FDC-22022M

Selection example of collet

- To clamp φ10.0 tool shank, both φ10.0 and φ10.5 collets are available. For higher accuracy, please select φ10.0 collet.
- Various types and sizes of collets are available. Please contact NT TOOL for details.

Ordering Example

FDC - 060 12M

Max. chucking dia.

MDC12 Series

Preset Screw

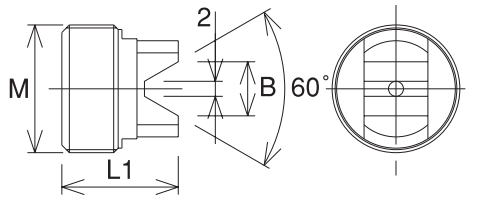

Code	Model	M	L1	B	Holder
2545 0000007	HDS-07	M8 P=1.0	14	5.5	MDC07
2545 0000012	HDS-12	M14 P=1.0	15.5	7.2	MDC12
2454 0000022	HDS-22	M23 P=1.0	17.5	9.5	MDC22

● Various types of preset screws are available. Please contact NT TOOL for details.

Retention Stud

Code	Model	Shank	Standard	Internal coolant feeding
0754 0000000	PSB-0	BT30	MAS-1	—
0754 0000100	PSB-0A	BT30	MAS-2	—
0754 0000003	PSB-3	BT40	MAS-1	—
0754 0000004	PSB-4	BT40	MAS-2	—
0754 1000000	PSB-0-CH	BT30	MAS-1	○
0754 1000100	PSB-0A-CH	BT30	MAS-2	○
0754 1000003	PSB-3-CH	BT40	MAS-1	○
0754 1000004	PSB-4-CH	BT40	MAS-2	○

● Various types of Retention Stud are available. Please contact NT TOOL for details.

NT TOOL CORPORATION in Japan

NT TOOL CORPORATION is the leading tool holder manufacturer in Japan chosen by 80% of the Japanese automotive manufacturers.

One of the strengths of NT is its deep knowledge gained from development and manufacturing of broad range of products such as NC tooling, special purpose machine tooling and much more.

NT's goal is to "Make all customers in the world happy with NT Products." With this belief, NT will make continuous effort to provide high quality and user friendly products to its customers.

NT TOOL (THAILAND) CO., LTD.

222 Moo 1 Hi-tech Industrial Estate, Banpho, Bang pa-in, Ayuthaya 13160 Thailand

Tel. 66-(0)3531-4180 Fax. 66-(0)3531-4182 E-Mail: nt_thai@ksc.th.com

PT. NT INDONESIA

Kawasan Industri Jababeka Tahap 6, Blok B 2A, Desa Jatireja, Kecamatan Cikarang Timur, Kabupaten Bekasi, 17530, Indonesia

Tel. 62-(0)212-851-8066 Fax. 62-(0)212-851-8067 E-Mail: nt-indonesia@nttool.co.jp

NT TOOL CORPORATION CHINA OFFICE

Room N, Floor15, MeiXin building, 728 The Xizangzhong Rd., Shanghai 200001 P.R.China

Tel. 86-(0)21-6361-9540 Fax. 86-(0)21-6360-7845 E-Mail: nt-shanghai@nttool.co.jp